

Kee Klamp® Fittings



- Quick and easy way to assemble Structural Pipe Systems.
- Galvanized Malleable Iron.
- Reduce labor costs by 70%.
- 100% reusable.
- No welding or threading.
- No drilling or bolting.

Kee Klamps are strong, malleable iron, **Slip-On Pipe Fittings** with from one to five case-hardened **Set Screws** per **Fitting** - depending on the number of **Pipes** to be joined at one joint.

For **Slip-On Aluminum Fittings**, turn to page 80.

View **Installation Instructions and Structural Information** at wagnercompanies.com.

3/4" Pipe = 1.05" Diameter
1" Pipe = 1.315" Diameter
1 1/4" Pipe = 1.66" Diameter
1 1/2" Pipe = 1.90" Diameter
2" Pipe = 2.375" Diameter

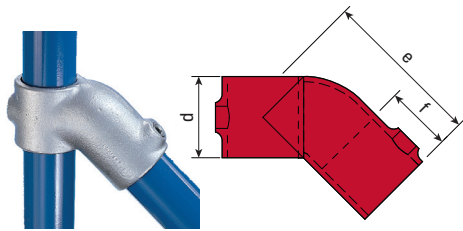

45° Single Socket Tee

Pipe Size	d	e	f	MALLEABLE IRON
1"	1.73"	3.35"	1.38"	KK12-6
1 1/4"	2.17"	3.70"	1.58"	KK12-7
1 1/2"	2.36"	4.25"	1.58"	KK12-8

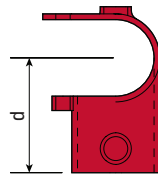

Clamp-On Tee

Pipe Size	d	MALLEABLE IRON
1 1/4"	2.68"	KK16-7
1 1/2"	2.87"	KK16-8
2"	3.54"	KK16-9

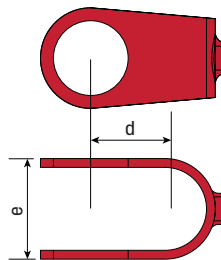
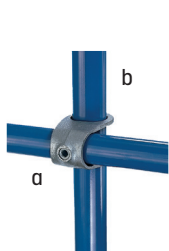

Clamp-On Crossover

Pipe Size a	Pipe Size b	d	e	MALLEABLE IRON
1"	1"	1.34"	1.89"	KK17-6
1 1/4"	1 1/4"	1.69"	2.28"	KK17-7
1 1/2"	1 1/2"	1.93"	2.56"	KK17-8
2"	2"	2.40"	3.07"	KK17-9

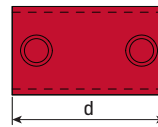

Straight Coupling

Pipe Size	d	MALLEABLE IRON
1"	3.50"	KK14-6
1 1/4"	4.01"	KK14-7
1 1/2"	4.09"	KK14-8
2"	4.88"	KK14-9

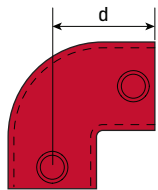

90° Elbow

Pipe Size	d	MALLEABLE IRON
1"	1.81"	KK15-6
1 1/4"	2.36"	KK15-7
1 1/2"	2.67"	KK15-8
2"	3.34"	KK15-9

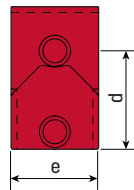
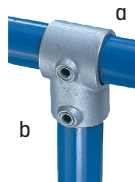

Single Socket Tee

Pipe Size (a)	Pipe Size (b)	d	e	MALLEABLE IRON
1"	1"	1.81"	1.84"	KK10-6
1"	3/4"	1.75"	1.42"	KK10-65*
1"	1 1/4"	2.20"	2.06"	KK10-67*
1 1/4"	1 1/4"	2.38"	2.16"	KK10-7
1 1/4"	3/4"	2.25"	1.44"	KK10-75*
1 1/4"	1"	2.25"	1.80"	KK10-76*
1 1/4"	1 1/2"	2.88"	2.38"	KK10-78*
1 1/2"	1 1/2"	2.69"	2.38"	KK10-8
1 1/2"	1 1/4"	2.47"	2.03"	KK10-87*
2"	2"	3.31"	2.88"	KK10-9
2"	1 1/2"	2.94"	2.50"	KK10-98*

* Through connection and terminal connection are different **Pipe** size.

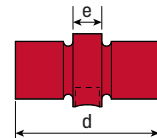

Internal Coupling

This **Coupling** is not to be used as a load bearing joint.

Pipe Size	d	e	MALLEABLE IRON
1"	2.99"	.79"	KK18-6
1 1/4"	2.99"	.79"	KK18-7
1 1/2"	3.74"	.79"	KK18-8

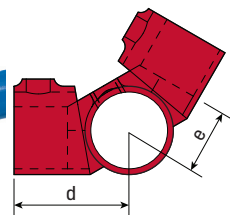
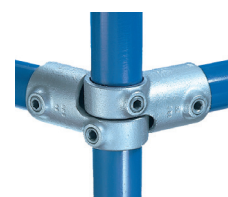

Adjustable Side Outlet Tee

Pipe Size	d	e	MALLEABLE IRON
1"	2.28"	1.30"	KK19-6
1 1/4"	2.87"	1.57"	KK19-7
1 1/2"	3.54"	2.17"	KK19-8
1 1/2"	2.87"	1.77"	KK19-85*
2"	4.33"	1.93"	KK19-9

*Connects 1 1/2" to 3/4" **Pipe**.

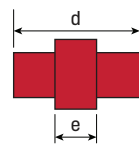

Internal Coupling

Pipe Size	d	e	MALLEABLE IRON
1 1/4"	2.93"	1.00"	KK514-7



Kee Klamp Video

STANDARD PRODUCTS

RAILING SYSTEMS

TRADITIONAL RAILING

CUSTOM SERVICES

APPENDIX