

DA150S-3

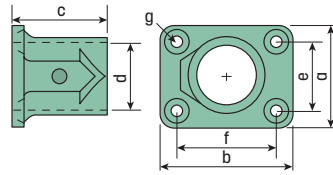

Rectangular Base Flange

Pipe Size	Tube OD	a	b	c	d	e	f	g	ALUMINUM
3/4"	1.05"	2 7/8"	1 5/8"	1 1/16"	1 1/16"	2 1/8"	1 1/16"	3/16"	DA150S-1*
1"	1.315"	2 1/8"	2 3/4"	2 1/16"	1 5/16"	1 7/16"	2"	1/4"	DA150S-2
1 1/4"	1.66"	2 9/16"	3 1/4"	2 7/16"	1 11/16"	1 5/8"	2 5/16"	1/4"	DA150S-3
1 1/2"	1.90"	3 1/16"	3 11/16"	2 11/16"	1 15/16"	2"	2 5/8"	5/16"	DA150S-4

* Two-hole Base



DA500-3

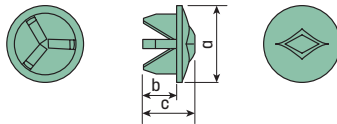

Plug

These **Plugs** are to close opening in **Fittings** - not **Pipe**. For **Pipe End Caps** and **Plugs**, refer to pages 88 or 67 - 69.

Pipe Size	Tube OD	a	b	c	ALUMINUM
3/4"	1.05"	1 3/16"	1/2"	3/4"	DA500-1
1"	1.315"	1 1/2"	1/2"	3/4"	DA500-2
1 1/4"	1.66"	1 7/8"	3/4"	1"	DA500-3
1 1/2"	1.90"	2 1/16"	3/4"	1"	DA500-4



DA150R-3

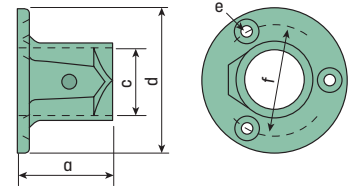

Round Base Flange

Pipe Size	Tube OD	a	c	d	e	f	ALUMINUM
3/4"	1.05"	1 5/8"	1 1/16"	2 1/2"	3/16"	2"	DA150R-1
1"	1.315"	2 1/16"	1 5/16"	3 1/8"	1/4"	2 3/8"	DA150R-2
1 1/4"	1.66"	2 7/16"	1 11/16"	3 1/2"	1/46"	2 13/16"	DA150R-3
1 1/2"	1.90"	2 11/16"	1 5/16"	4"	5/16"	3 1/4"	DA150R-4

In-Ground Socket

For Pools and Removable Rails.

This heavy-duty cast **Socket** for 1 1/2" **Pipe** mounts flush with ground surface. A Stainless Steel locking bolt secures the post and resists corrosion. The railing is easily removed by loosening the lock bolt. Use heavy duty Stainless Steel **Cover Flange** for neat looking installation. An electrical ground cover screw is furnished.



Perma-Socket

Pipe Size	Tube OD	Depth	ALUMINUM
1 1/2"	1.90"	4"	PS-4019



DA160-3

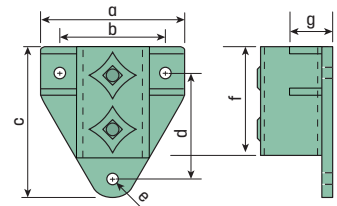

Wall Flange

Pipe Size	Tube OD	a	b	c	d	e	f	g	ALUMINUM
1"	1.315"	3 1/2"	2 5/8"	3 3/8"	2 5/16"	5/16"	2 1/2"	1 1/16"	DA160-2
1 1/4"	1.66"	3 11/16"	2 7/8"	3 5/8"	2 9/16"	3/8"	2 11/16"	1 3/16"	DA160-3
1 1/2"	1.90"	4 3/8"	3 3/8"	3 7/8"	2 5/8"	3/8"	2 7/8"	1 5/16"	DA160-4



2614

Cover Flange

Mill Finish

Pipe Size	Tube OD	304 STAINLESS
1 1/2"	1.90"	2614

STANDARD PRODUCTS

RAILING SYSTEMS

TRADITIONAL RAILING

CUSTOM SERVICES

APPENDIX