

# Socket Weld Pipe Fittings



These **Fittings** are designed to **fit over the Pipe** size as noted.

*In your shop* - fabricate **Pipe Posts** complete with **Elbows, Tees, Crosses** and **Flanges**.

*In the field* - slip top rails through the **Tees**, place middle rails into **Crosses** and then weld.

Formed **Fittings** have an open seam. Welded seam is available.

Supplied in mill finish. Other finishes available upon request; contact [rfq@mailwagner.com](mailto:rfq@mailwagner.com).

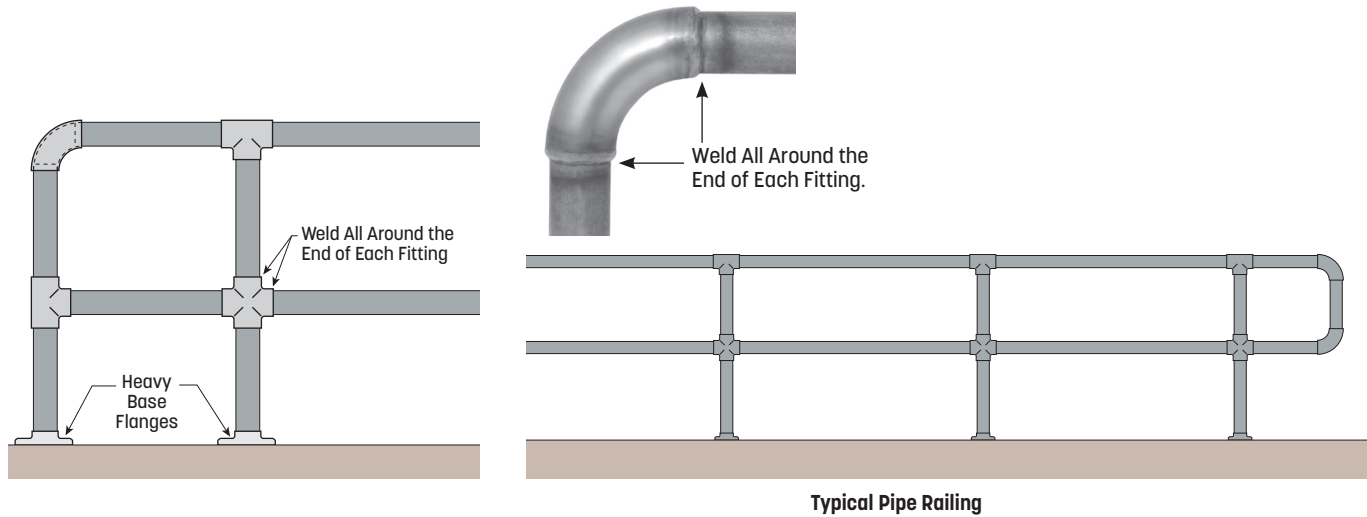

Typical Pipe Railing

## Socket Weld Tee

Fits Over Pipe Size	Tube OD	a	STEEL	3003 ALUMINUM
1/4"	1.66"	3.75"	2106	2124
1/2"	1.90"	4.12"	2110	

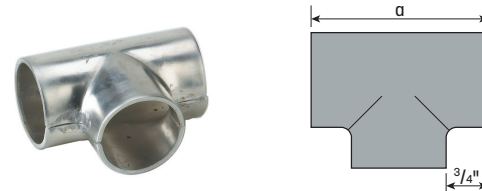

## 90° Socket Weld Elbow

Fits Over Pipe Size	Tube OD	a	STEEL	6063 ALUMINUM
1/4"	1.66"	2.00"	7956	7972
1/2"	1.90"	3.38"	2109	

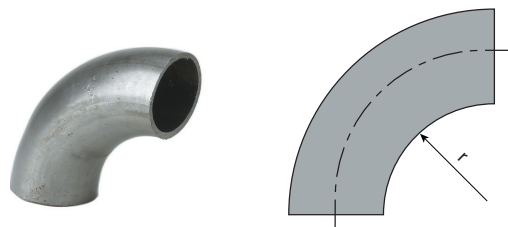

## Socket Weld Cross

Fits Over Pipe Size	Tube OD	a	STEEL	3003 ALUMINUM
1/4"	1.60"	3.75"	2108	2126
1/2"	1.90"	4.12"	2112	

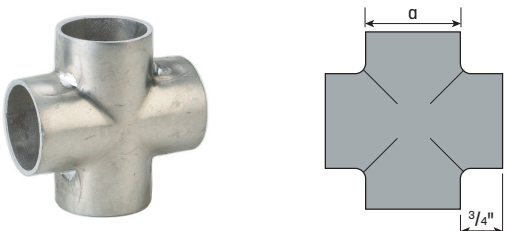

STANDARD PRODUCTS

RAILING SYSTEMS

TRADITIONAL RAILING

CUSTOM SERVICES

APPENDIX