

Fabric Mounting Hardware & U-Brackets

Weld Mount

- 3/16" thick with 3/8" hole
- Packages of 25



21-25

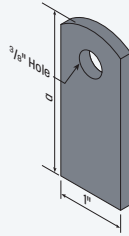

Weld Mount

- 3/16" thick with 3/8" hole
- Packages of 25



33-25

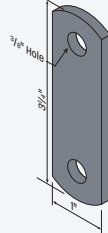

Zee Brackets

- 10 Ga. thick
- Packages of 25



43P-25

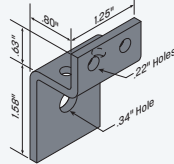

Zee Brackets

- 10 Ga. thick packages of 25



46P-25

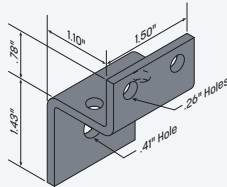

U-Bracket

All U-Brackets are made for a friction fit. For clearance-fit, add spacers beneath the mounting area. All holes are 7/16" diameter.

- 2" wide, 3/16" thick (except as noted)
- Fascia mount



3741

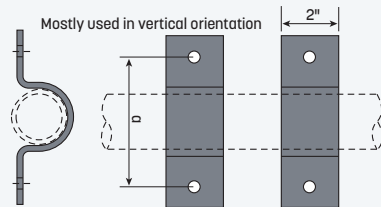

U-Bracket

All U-Brackets are made for a friction fit. For clearance-fit, add spacers beneath the mounting area. All holes are 7/16" diameter.

- 4 3/8" high, 3/16" thick
- Fascia mount



3682

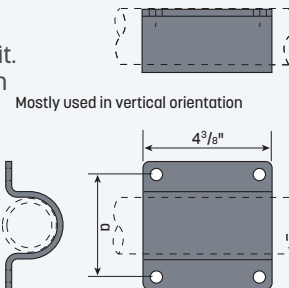

Height	Thick.	Steel	Zinc Plated Steel	Aluminum
1 1/2"	3/16"	21-25	21P-25	22-25
2 3/8"	3/16"	23-25	23P-25	24-25

Thick.	Steel	Zinc Plated Steel	Aluminum
3/16"	33-25	33P-25	34-25

Material	Part Number
Steel	43-25
Zinc Plated Steel	43P-25
Aluminum	44-25

Material	Part Number
Zinc Plated Steel	46P-25
Aluminum	47-25
Stainless Steel	48-25

Pipe Size	Tube OD	α	Steel	3003 Aluminum	304 Stainless
1"	1.315"	3 3/4"	3741*		
	1.50"	4 1/2"	3722	3722A	3722-SS
1 1/4"	1.66"	4 1/2"	3750*	3756*	3762-SS
1 1/4"	1.66"		3750-NH*		
1 1/2"	1.90"	4 1/2"	3752*	3758	3764-SS
1 1/2"	1.90"		3752-NH	3758-NH*	
	2.00"	4 1/2"	3723	3723A	
2"	2.375"	4 1/2"	3754*	3760*	3766-SS
2 1/2"	2.875"	5 3/4"	3755*		

Pipe Size	Tube OD	α	Steel	3003 Aluminum	304 Stainless	Satin Stainless
1 1/4"	1.66"	3 1/2"	3682	3683	3682-SS	3682-SS.4
1 1/4"	1.66"		3682-NH			
1 1/2"	1.90"	3 1/2"	3684	3685	3684-SS	
1 1/2"	1.90"		3684-NH	3685-NH		
	2.00"	3 1/2"	3727	3727A	3727-SS	
2"	2.375"	4"	3684A	3685A	3685-SS	

"-NH" denotes part with no holes
 * 1/4" thick if aluminum alloy 5052

