

Round Tubing

.050" Wall Thickness,
Satin or Bright Polished Finish.

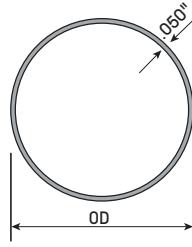

Tube OD	Length	TYPE 304 SATIN STAINLESS	TYPE 304 POLISHED STAINLESS	C270 SATIN BRASS	C270 POLISHED BRASS
1.50"	4'	T3774.4L-4	T3774-4	T5062.4-4	T5062-4
1.50"	6'	T3774.4L-6	T3774-6	T5062.4-6	T5062-6
1.50"	8'	T3774.4L-8	T3774-8	T5062.4-8	T5062-8
1.50"	12'			T5062.4	T5062
1.50"	20'	T3774.4L	T3774		
2.00"	4'	T3970.4L-4	T3970-4	T5122.4-4	T5122-4
2.00"	6'	T3970.4L-6	T3970-6	T5122.4-6	T5122-6
2.00"	8'	T3970.4L-8	T3970-8	T5122.4-8	T5122-8
2.00"	12'			T5122.4	T5122
2.00"	20'	T3970.4L	T3970		

Note: We are unable to bend .050" wall **Tubing**. We will quote .125" wall annealed Brass with a minimum 2.75" center line radius.

Adjustable Saddle Bracket

Adjustable Brackets may be mounted to the top of **Posts** or at ends of mid **Rails** to adjust **Railing** to varying stair angles.

Tube OD	d	c	POLISHED BRASS
1.50"	1 1/2"	2 7/8"	141539
2.00"	2"	3 1/8"	142039

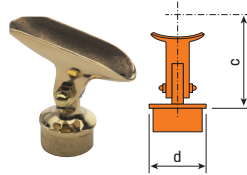

Ball Adjustable Saddle Bracket

Tube OD	d	c	POLISHED STAINLESS	POLISHED BRASS
1.50"	1 1/2"	3 5/8"	151538	142038
2.00"	2"	2 7/8"	152038	142038

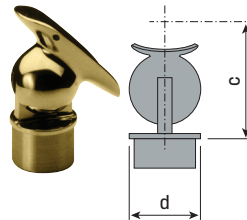

Cast Wall Mounting Brackets for Tube

Saddle fits 1.50" and 2.00" OD Stainless Steel and Brass **Tube**. Refer to pages 6 - 26 for other available **Brackets**.

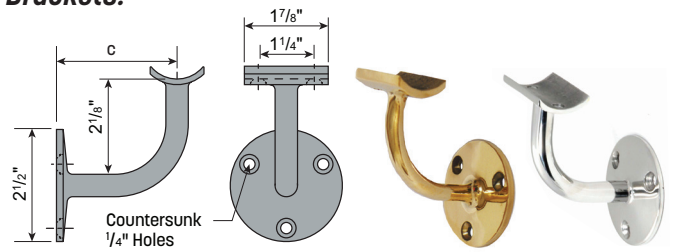

Tube OD	c	SATIN STAINLESS	POLISHED STAINLESS	POLISHED BRASS
1.50"	2 1/2"	151534.4	151534	
1.50"	2 5/8"			141534
2.00"	2 3/4"	152034.4	152034	
2.00"	2 5/8"			142034

Please review our quality expectations statement on page 223.

LOCTITE® Adhesive and Primer

A single component, structural **Adhesive** which may be used as an alternative to welding, soldering or **Set Screwing** Brass and Stainless Steel **Fittings** and **Tubing**. Not for use with Aluminum. **Primer** is recommended with Stainless Steel components for the purpose of speeding up cure time.

Approximately 10-15 joints are typical per container.

Adhesive	1.10 Ounces	14664
Primer	0.88 Ounces	14666



See page 99 for **Lido-Lustre™ Polish Cream**.

Steel Reinforcing Insert

Insert this **Steel Insert** into your Brass or Stainless Steel **Tubing** for added strength in **Posts**, **Foot Rails** or as required. When used in **Foot Rails**, drill pilot holes to accept **Screws** supplied with **Fittings**.

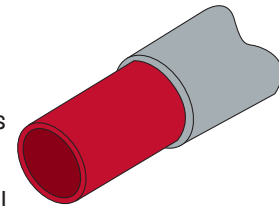

Tube OD	Insert OD	4' LENGTH STEEL	6' LENGTH STEEL	8' LENGTH STEEL	20' LENGTH STEEL
1.50"	1.375"	T1269-4	T1269-6	T1269-8	T1269
2.00"	1.875"	T1360-4	T1360-6	T1360-8	T1360

Internal Splice

Insert into Brass or Stainless Steel **Tube** with **Lido-Weld Adhesive** for **Tube Splice** connections. **Splice** should be within 6" of a **Post** or **Bracket** connection.

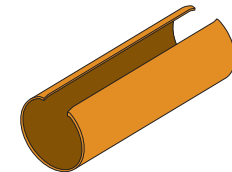

Tube OD	Length	BRASS
1.50"	6"	14621-15
2.00"	6"	14621-2

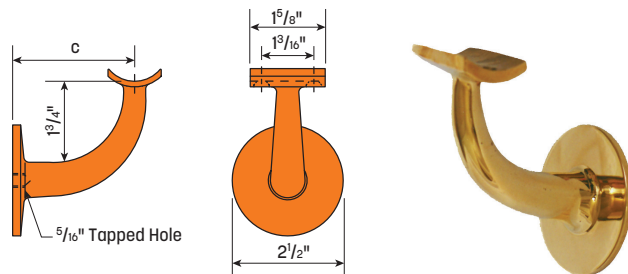

5/16" **Hanger Bolt** is included.

Tube OD	c	POLISHED BRASS
1.50"	2 3/4"	141535
2.00"	2 3/4"	142035