

Kee Klamp® Fittings

90° Side Outlet Tee

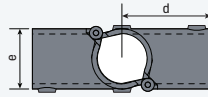

KK21

Pipe Size	OD Size	d	e	Malleable Iron
1 1/2"	1.90"	3.46"	2.36"	KK21/A26-8

90° Side Outlet Tee

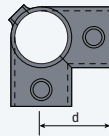

KK21-7

Pipe Size	OD Size	d	Malleable Iron
1"	1.315"	1.81"	KK21-6
1 1/4"	1.66"	2.36"	KK21-7
1 1/2"	1.90"	2.68"	KK21-8
2"	2.375"	3.35"	KK21-9

30° to 60° Single Socket Tee

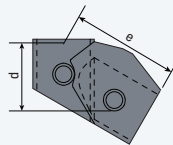

KK29-7

Pipe Size	OD Size	d	e	Malleable Iron
1"	1.315"	3.23"	2.52"	KK29-6
1 1/4"	1.66"	3.66"	2.91"	KK29-7
1 1/2"	1.90"	4.02"	2.68"	KK29-8

Adjustable Cross

KK30 is adjustable between 30° and 45° from the horizontal.

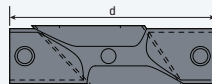

KK30-7

Pipe Size	OD Size	d	Malleable Iron
1"	1.315"	5.75"	KK30-6
1 1/4"	1.66"	7.01"	KK30-7
1 1/2"	1.90"	8.50"	KK30-8

90° Three Socket Tee

For use when splicing pipe within the tee.

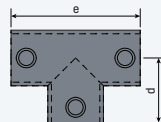

KK25-7

Pipe Size	OD Size	d	e	Malleable Iron
1"	1.315"	1.81"	3.62"	KK25-6
1 1/4"	1.66"	2.36"	4.72"	KK25-7
1 1/2"	1.90"	2.68"	5.35"	KK25-8
2"	2.375"	3.35"	6.61"	KK25-9

Two Socket Cross

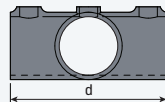

KK26-7

Pipe Size	OD Size	d	Malleable Iron
1"	1.315"	3.62"	KK26-6
1 1/4"	1.66"	4.72"	KK26-7
1 1/2"	1.90"	5.35"	KK26-8
2"	2.375"	6.61"	KK26-9