

# Kee Klamp® Fittings

## Adjustable Side Outlet Tee

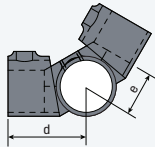

KK19-7

Pipe Size	OD Size	d	e	Malleable Iron
1"	1.315"	2.28"	1.30"	KK19-6
1 1/4"	1.66"	2.87"	1.57"	KK19-7
1 1/2"	1.90"	3.54"	2.17"	KK19-8
2"	2.375"	4.33"	1.93"	KK19-9

## Clamp-On Crossover

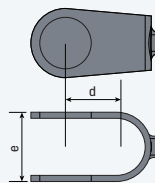

KK17-7

Pipe Size (a)	Pipe Size (b)	OD Size	d	e	Malleable Iron
1"	1"	1.315"	1.34"	1.89"	KK17-6
1 1/4"	1 1/4"	1.66"	1.69"	2.28"	KK17-7
1 1/2"	1 1/2"	1.90"	1.93"	2.56"	KK17-8
2"	2"	2.375"	2.40"	3.07"	KK17-9

## Internal Coupling

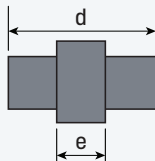

KK514-7

Pipe Size	OD Size	d	e	Malleable Iron
1 1/4"	1.66"	2.93"	1.00"	KK514-7

## Single Socket Tee



KK10-6

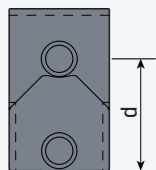

Pipe Size (a)	Pipe Size (b)	OD Size	d	e	Malleable Iron
1"	1"	1.315"	1.81"	1.84"	KK10-6
1"	3/4"	1.315"/1.05"	1.75"	1.42"	KK1065*
1"	1 1/4"	1.315"/1.66"	2.20"	2.06"	KK10-67*
1 1/4"	1 1/4"	1.66"/1.66"	2.38"	2.16"	KK10-7
1 1/4"	3/4"	1.66"/1.05"	2.25"	1.44"	KK10-75*
1 1/4"	1"	1.66"/1.315"	2.25"	1.80"	KK10-76*
1 1/4"	1 1/2"	1.66"/1.90"	2.88"	2.38"	KK10-78*
1 1/2"	1 1/2"	1.90"/1.90"	2.69"	2.38"	KK10-8
1 1/2"	1 1/4"	1.90"/1.66"	2.47"	2.03"	KK10-87*
2"	2"	2.375"/2.375"	3.31"	2.88"	KK10-9
2"	1 1/2"	2.375"/1.90"	2.94"	2.50"	KK10-98*

## Side Outlet Elbow



KK20-5

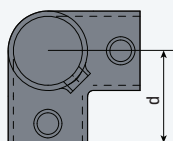

Pipe Size	OD Size	d	Malleable Iron
1"	1.315"	1.81"	KK20-6
1 1/4"	1.66"	2.36"	KK20-7
1 1/2"	1.90"	2.68"	KK20-8
2"	2.375"	3.35"	KK20-9

\* Through connection and terminal connection are different pipe sizes

Learn more or order at [WagnerCompanies.com](http://WagnerCompanies.com)

