

# Ball Style Fittings

Cast aluminum fittings with a tumbled finish and set screws.

Ball style railing fittings were very popular during the late 19th and early 20th centuries. These are still commonly seen along the ocean and in older facilities.

For use with 1 1/2" aluminum pipe—1.90" OD.

*Note: Set screw assembly is not recommended for structural applications. Welded assemblies will provide best structural performance.*

## Aluminum Pipe

Alloy 6063, 20' lengths.

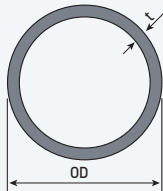

Pipe Size	Sch.	OD	ID	t	lb/ft	Aluminum
1 1/2"	40	1.90"	1.610"	.145"	.940	P540

## Elbow

Includes two 3/8-16 set screws.



WR210

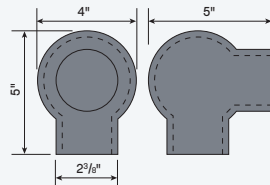

Pipe Size	OD	Aluminum
1 1/2"	1.90"	WR210

## Tee

Includes three 3/8-16 set screws.



WR220

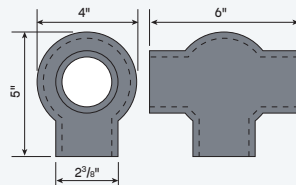

Pipe Size	OD	Aluminum
1 1/2"	1.90"	WR220

## Cross

Includes four 3/8-16 set screws.



WR230

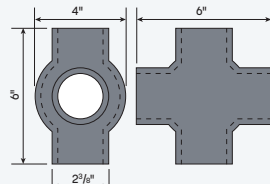

Pipe Size	OD	Aluminum
1 1/2"	1.90"	WR230

## Single Outlet

Includes one 3/8-16 set screws.



WR260

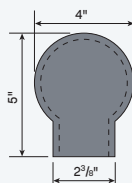

Pipe Size	OD	Aluminum
1 1/2"	1.90"	WR260